



HI

Industrial
85 pound
125 pound

Washer

Extractor

Extractor





HI Series - *HARDMOUNT*

The HI series - Hardmount High Speed Industrial Strength Washer-Extractors for Medium Size On-Premises Laundry Applications, including Health Care, Hospitality, Correctional Institutions and on Board ship installations

Professional Performance, Built to Last, Flexible and Energy Efficiency. A Competitive and Affordable Investment Alternative

The HI series is designed to be an alternative to the commonly used high-speed Hardmount machines in the market. This series of machines has the cabinet and all parts in connection with the wash solution made of 304 stainless steel. The robust design ensures low cost of ownership and infrequent maintenance. Experienced engineering is used to design these strong and surprisingly affordable and reliable machine. The HI series has advanced features That make these machines suitable for wet cleaning, water reuse systems and operation with ozone systems. Our combined engineering expertise plus an outstanding warranty assures that you will receive the best for less and products that will meet today and tomorrow's need in the laundry.

Powerful Advanced Computer Control Center

The advanced EL 6 electronic control center is easy to use and has the features needed for maximum productivity and lowest cost of operation. The microprocessor controls the temperatures, water levels, speeds and maintenance intervals. A thermal cool down is programmable that will ensure optimal performance for any garments that require special wrinkle control and other special treatments. It can be programmed both individual and with a PC. It can also be used with a memory card that significantly simplifies the programming at installation. The EL 6 can be programmed to display in five languages and keep track of operation times, number of cycles and maintenance. It has features for programming any wash activity to meet today and tomorrow's demand for water treatment of textile fiber and garments. It is the most flexible control yet developed for the stand-alone commercial and industrial washers in the industry and has proven track record for reliability.



Large Robust Door with an oversized Door Opening



Loading and unloading are fast and easy through the oversized door that opens 180 degrees. The door is constructed of stainless steel and built with an oversize stainless steel hinge for extra strength and durability, and is located at a convenient height for laundry carts. This is the same heavy-duty design as used on our industrial strength high-speed freestanding washer-extractors. The silicon door gasket is made of best material for long life. It seals to shell every time without leaking. A powerful and save electro-mechanical door interlocking system is provided for safe and easy operation. Double fail-safe technology provides peace of mind for the life of the equipment.

High Speed Industrial Washer - Extractors



Supply Dispenser and External Liquid Supply Connection

A five (5) compartments dispenser for both liquid and powder detergents is standard. The dispenser is mounted on the left side of the machine at a convenient height for easy reach (model HI125). The dispenser is flushed automatically during the wash cycle. All machines are provided with a six (6) supply signals and liquid connections as standard equipment.

Power and reliability at work - Bearings and Seals

The machines are provided with spherical roller bearings mounted in cast steel housings. The bearings are located outside of the wash solution and will not be damaged if the seals leak. The cylinder shaft is constructed from high tensile strength steel and hard chromed for corrosion resistance. Seals are easy to access and replace. V-Belts and heavy-duty pulleys provide a safe and long lasting drive system.



HI-125

Robust Energy Efficient Drive



The machine is provided with a single totally enclosed standard motor that is controlled electronically by a variable frequency drive. The inverter reduces the peak energy demand, saves energy and lowering the inrush current. It is also a watchdog for the motor, protecting against overload and over voltage. The single motor drive and inverter eliminates clutches, gear reducers, and idlers while reducing the use of electromechanical components such as contactors and relays. It provides a powerful yet simple drive alternative that is more economical than multi motor drives. The inverter makes it possible to achieve higher extract speeds, which significant saves energy and time saving in the drying process, and allows the machine to operate with single-phase or three-phase power.

Solid Mount Heavy Duty Construction

Amazing strength and fewer parts give the HI series extra long life, without needless breakdowns. The frame is engineered to ensure for a lifetime of rigorous operation. It provides for maximum stability and durability and has a protective powder coating to reduce possible corrosion and prolong life. You won't find another hardmount washer-extractor built stronger than the HI Series.



Specifications

MODEL	US	Metric	HI - 85	HI - 125
Maximum Capacity	Lbs.	Kgs.	85 (38.6)	125 (56.7)
Overall Dimension :				
A - Width	Inch.	mm.	43.7 (1110)	50.98 (1295)
B - Depth	Inch.	mm.	53.3 (1355)	61.2 (1555)
C - Height	Inch.	mm.	62.6 (1590)	65.7 (1670)
Wash Cylinder Information :				
Basket Diameter	Inch.	mm.	36 (914)	42 (1060)
Basket Depth	Inch.	mm.	24 (610)	24 (610)
Basket Volume	Cu.ft.	Cu.m.	14.1 (0.4)	19 (0.54)
Motor :				
Size	HP	kW	7.5 (5.5)	10 (7.5)
Cylinder Speeds (Programmable) :				
Wash	rpm	G	40 (0.8)	36 (0.8)
Distribution	rpm	G	70 (2.5)	60 (2)
Intermediate extraction	rpm	G	-	260 (40)
High extract 1	rpm	G	325 (54)	380 (85.5)
High extract 2	rpm	G	408 (85)	485 (139)
High extract 3	rpm	G	630 (202.5)	580 (199)
Door Opening :				
Door Opening Diameter	Inch.	mm.	20 (508)	20 (508)
Height to bottom of door	Inch.	mm.	25.98 (660)	27.5 (700)
Drain System :				
Overflow Size	Inch.	mm.	2.5 (63.5)	2.5 (63.5)
Drain Outlet Size	Inch.	mm.	3 (76.2)	3 (76.2)
Number of Drain Outlet	Standard	Optional	1 (2)	1 (2)
Steam Inlet :				
Connection Size	NPT		3/4"	3/4"
Water Inlet :				
Connection Size	NPT		1	1
Number of Inlets	Standard	Optional	2	2
Chemical Supply System :				
Number of Dry Chemical Compartments	Standard	Optional	3	5
Number of Liquid Supply Connections	Standard	Optional	3	5
Liquid Supply Connection Size	NPT		1/2"	1/2"
Weight and shipping Information :				
Net weight	Lbs.	Kgs.	1700 (771)	2753 (1249)
Domestic Shipping Weight	Lbs.	Kgs.	1921 (871)	3085 (1399)

Specification and Design subject to change without notice
Additional options : Consult factory or distributor

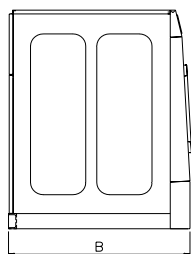
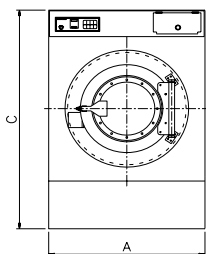

HI 85

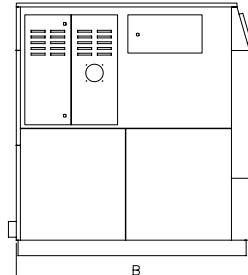
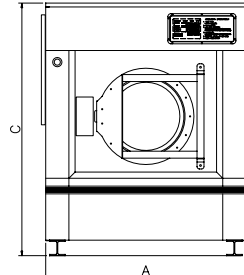

HI 125

Standard Features :

- All wetted parts are 304 (18/8) stainless steel
- 5 compartment supply dispensers
- 6 external liquid supply connections
- Advanced microprocessor
- 200 G extract force
- 5 degrees lean back for strength and easy loading
- Variable frequency drive
- Stainless steel cabinet
- Single motor drive
- Cool down
- Water reuse capable

Optional Features :

- Direct steam heating
- Electrical heating
- 5 compartment dispenser
- Water reuse drain and inlet
- EMI filter for CE
- PC programming kit



Conforms to all applicable US and Canadian safety standards.

B&C Technologies
Panama City, FL
Phone: 850-249-2222
FAX: 850-249-2226
www.bmctechnologies.com
sales@bmctechnologies.com